

Panasonic

Operating Instructions (Household use) Body Hair Trimmer Model No. ER-GK20

English.....3

中文23



Panasonic

English

Operating Instructions
(Household use) Body Hair Trimmer
Model No. ER-GK20

Contents

Safety precautions.....	4
Parts identification	8
Installing the battery	9
Read before use.....	10
How to use	12
Maintenance.....	15
Troubleshooting	20
Specifications	21



Thank you for purchasing this Panasonic product.
Before operating this unit, please read these instructions
completely and save them for future use.

Safety precautions



To reduce the risk of injury, loss of life, electric shock, fire, and damage to property, always observe the following safety precautions.

Explanation of symbols

The following symbols are used to classify and describe the level of hazard, injury, and property damage caused when the denotation is disregarded and improper use is performed.

 WARNING	Denotes a potential hazard that could result in serious injury or death.
 CAUTION	Denotes a hazard that could result in minor injury or property damage.

The following symbols are used to classify and describe the type of instructions to be observed.

	This symbol is used to alert users to a specific operating procedure that must not be performed.
	This symbol is used to alert users to a specific operating procedure that must be followed in order to operate the unit safely.

 **WARNING****► Preventing accidents**

Do not store within the reach of children or infants. Do not let them use it.



- Putting parts or accessories in the mouth may cause an accident or injury.



Immediately stop using if there is an abnormality or malfunction.

- Failure to do so may cause fire or injury.

If the oil is consumed accidentally, do not induce vomiting, drink a large amount of water, and contact a physician.



If the oil comes into contact with eyes, immediately wash thoroughly with running water, and contact a physician.

- Failure to do so may result in physical problems.

This appliance is not intended for use by persons (including children) with reduced physical, sensory or mental capabilities, or lack of experience and knowledge, unless they have been given supervision or instruction concerning use of the appliance by a person responsible for their safety.



Children should be supervised to ensure that they do not play with the appliance.

- Failure to do so may cause an accident or injury.



CAUTION

► **To protect your skin**

Do not press the blade strongly on the skin.

Do not use this product for any purpose other than trimming body hair.

Do not use this product without an attachment to trim hair in the following areas: sensitive zones, buttocks, anus, and surrounding areas.



Do not use in the following body area:

- **Face or head (hair, beard, etc.)**
 - **Areas with rough or bumpy skin (swollen areas, cuts, hemorrhoids, and other protuberances; nipples and surrounding areas)**
 - **Moles, bruises, etc.**
- Doing so may cause skin injury.

Do not press the blade with excessive force.

Also, do not touch blade with nails.



Do not bring the blade into contact with hard objects.

- Doing so may cause the blade to become damaged and injure the skin as the blade is very thin. Be careful when using it.



Check the blade for deformation or damage before use.

- Failure to do so may cause skin injury.



When storing or carrying, always attach the attachment.

- Failure to do so may cause injury to the skin or reduce the life of the blade.
-



CAUTION

► This product



Do not share with your family or others.

- Doing so may result in infection or inflammation.



Do not drop or subject to shock.

- Doing so may cause injury.



Do not modify, disassemble or repair.

- Doing so may cause an accident or injury.

- Contact an authorized service center for repair.

► The battery



Do not throw into fire or disassembly.

The supply terminals are not to be short-circuited.

- Doing so may cause a burn or injury.

Always follow the cautions printed on the battery.

Check the polarity of the battery (+ and -) and install it correctly.

Remove the battery immediately and dispose of it safely when it is discharged.



Remove the battery when not using the appliance for an extended period of time.

Use the battery by the recommended use-by date.

Non-rechargeable battery is not to be recharged.

- Failure to do so may cause overheating or explosion of the battery, injury or contamination of surroundings due to leakage.

Parts identification

English

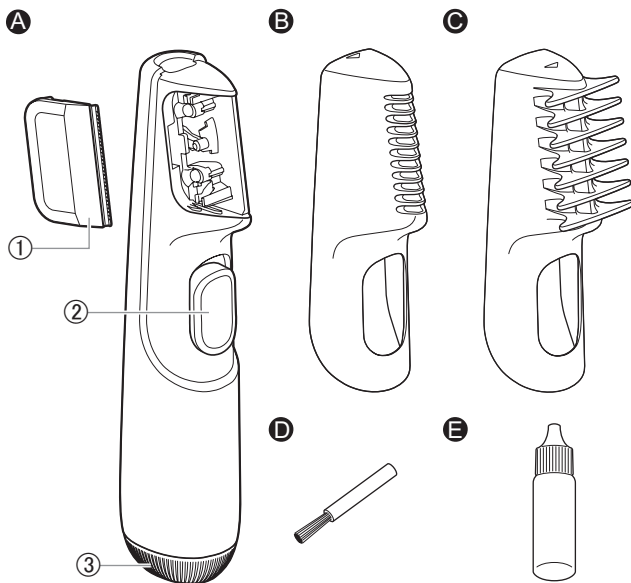

A Main body

- ① Blade
 - ② Power switch [O/I]
 - ③ Battery cover
- B Attachment for groin**
- C Length adjustment comb attachment (3 mm)**

Accessories

- D Cleaning brush**
- E Oil**

Alkaline battery is not enclosed.

Installing the battery

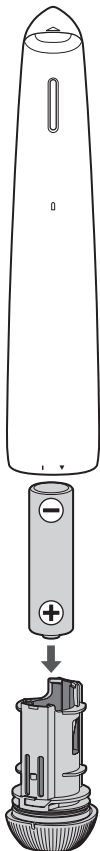

• Make sure that the main body is turned off.

1. Remove the battery cover.

Turn the notch on the battery cover in the direction of the arrow until the battery cover is removed.

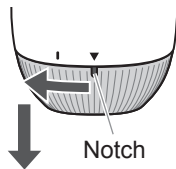

2. Check the polarity (+ and -) and install the battery.

Thoroughly wipe the main body to prevent water droplets from getting inside when installing the battery.

3. Attach the battery cover.

(1) Align the notch on the battery cover with the “I” mark and insert the battery cover.

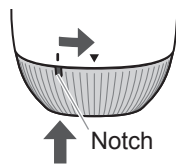

(2) Rotate the battery cover until the notch is aligned with the “▼” mark on the main body.

Notes







- You can use the appliance for approximately 3 months with one Panasonic LR6 (AA alkaline battery). (When used for approx. 5 minutes at one time, once a week in a room temperature of 20 °C.)
- Be sure to use LR6 (AA alkaline battery).

Read before use

English

Areas of use

✓ OK x Do not use

Area		When used with an attachment	When used without an attachment
Sensitive zones			
<ul style="list-style-type: none"> • Genitalia • Genital area • Crotch 		✓	x
<ul style="list-style-type: none"> • Buttocks • Anus • Perianal region 		✓	x
Armpits		✓	✓
Chest		✓	✓
Navel area		✓	✓
Arms, hands		✓	✓
Legs		✓	✓

- Using this appliance to trim hair in areas that are not visually accessible may result in cuts or injury. Please use with care.

- Using the main body to trim hair in the shaded areas () below may result in cuts or injury.
Be sure to use an attachment.

Sensitive zones



Buttocks



Notes

- Stretch the skin on the areas with loose or flabby skin, or with wrinkles, and lightly apply the edge of the blade or attachment.
- Do not use the attachment on wet hair.
Wet hair might clump or stick to the skin, becoming hard to trim.
If you use the attachment to trim wet hair, you may not be able to achieve a uniform trim.
- For areas with thick or dense hair growth, trim a bit at a time. Hair sometimes gets caught or builds up in the attachment. When this happens, clean the attachment. (See pages 15~17)

How to use

Lightly apply the main body to your skin and shave while trying it out if you are using it for the first time.

Preparations

- Check that the blades are not damaged or deformed before use.
- Apply the oil to the blade before and after each use. (See page 18)

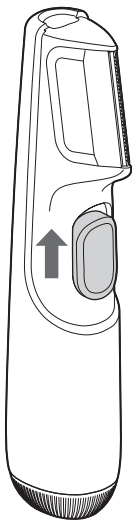

Trimming dry hair

- Use the appropriate attachment as needed. (See pages 13~14)

Trimming wet hair

- Do not use the attachment when trimming wet hair.
- Wet and apply soap beforehand to the area to be shaved.
- Apply less pressure than you would when trimming dry hair, and move the main body in a gliding motion.

1. Slide the power switch to turn on the appliance.

Applying to the skin and moving the main body. (See pages 13~14)

2. Slide the power switch to turn off the appliance after use.

- **Clean the appliance after each use.**
 - Failure to do so may cause blade to lose sharpness. (See pages 15~17)

Without attachment



Apply light pressure and slowly move the main body against the direction of hair growth.

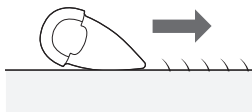

- To trim navel hair, lay the blade flat against your skin and then move the main body in a gliding motion. This allows you to trim hair down to a length of approximately 0.1 mm.
- It does not matter which side of the blade you lay against your skin. (See page 10)

Attachment for groin



Lightly apply the edge of the attachment for groin against your skin and then slowly move the main body.

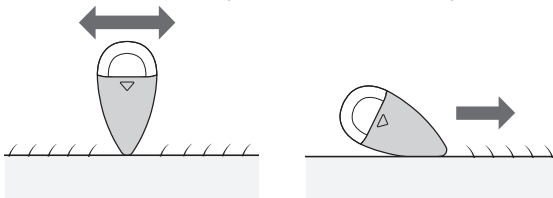

This allows you to safely trim hair down to a length of approximately 2 mm.

Length adjustment comb attachment



Lightly apply the edge (flat part) of the length adjustment comb attachment against your skin and then slowly move the main body.

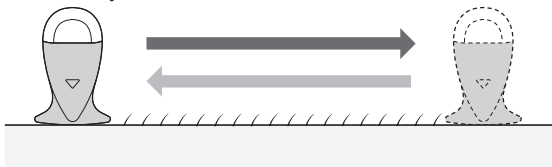

This allows you to trim hair down to a length of approximately 3 mm.

Removing and mounting the attachment

- Make sure that the main body is turned off.

How to remove

Holding the main body as shown in the figure, remove the attachment while pressing with your index finger and thumb.

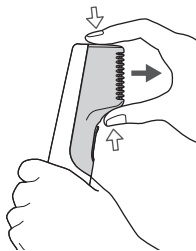

How to mount

Put the attachment on as indicated by the arrow.

- Make sure that the attachment does not come off.

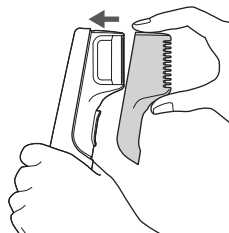

- The illustration shows the attachment for groin.

- All the attachments have the same method of removing and mounting.

Maintenance

Cleaning

- Clean the main body and the blade after each use.
(If left uncleaned, it will affect the blade sharpness and overall performance.)
- Make sure that the main body is turned off.
- Be sure to clean the appliance with the battery cover attached.
- Do not use thinner, benzine, alcohol or other chemicals. Doing so may cause failure, cracking or discoloration of the main body. Wipe the main body only with a soft cloth slightly dampened with tap water or soapy tap water.
- Store the main body in a place with low humidity after use. Failure to do so may cause malfunction due to condensation or rust.
- After cleaning, mount the attachment for storage.

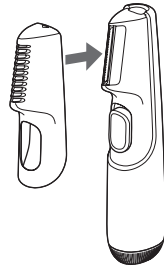

► With water

**To remove light dirt
(Water-through cleaning)**

1. Remove the attachment.
2. Turn on the power, and run water down the water inlet at the back of the main body to rinse thoroughly (for approximately 20 seconds).
 - Turn the trimmer off.

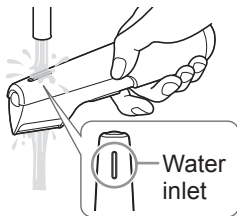
**To remove heavy dirt**

1. Remove the attachment and blade.
2. Rinse with running water.

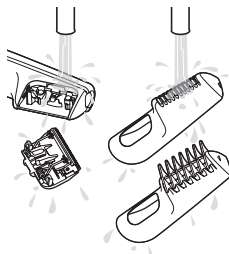

3. Shake up and down several times to remove the water.

- Be careful not to hit the main body on the sink or any other object while draining the water. Failure to do so may cause malfunction.

4. Wipe off the water with a towel and let it dry naturally.

- It will dry faster with the blade removed.

5. Apply the oil to the blade after drying. (See page 18)

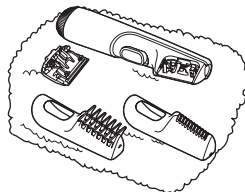

► With the brush

1. Brush off hair trimmings if any.

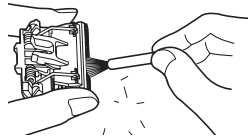
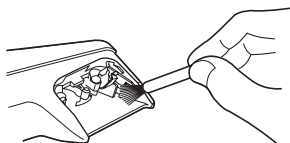

- Clean between the blades while pressing down the cleaning lever.

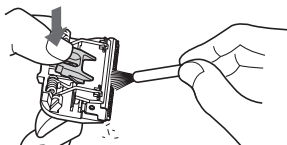

**2. Apply the oil to the blade after cleaning.
(See page 18)**

Lubrication

Apply the oil to the blade before and after each use.

1. Remove the blade.
(See page 19)
2. Apply a drop of the oil to each indicated point.
3. Attach the blade to the main body, turn on the power and allow to run for approximately 5 seconds.

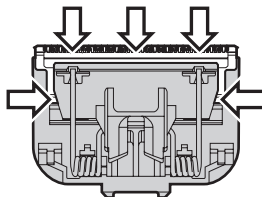

► Replacement part

Replacement part is available at your dealer or Service Center.

Replacement part for ER-GK20	Blade	WER9500
---------------------------------	-------	---------

Removing and mounting the blade

- Please check if the blade is deformed or damaged before removing and mounting it.
- Make sure the main body is turned off.

English

Removing the blade

1. Hold the main body, as illustrated.
2. Push the metal part of the blade to the left with the thumb's belly.
 - It is no problem when touch the blade by fingers.
 - Be careful not to let the blade fall.

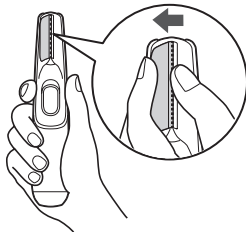

Mounting the blade

1. Fit the mounting hook (B) into the blade mounting (A) on the main body and then push in until you hear a click.

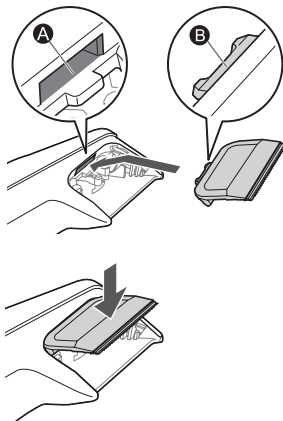

Troubleshooting

English

Problem	Action
The cutting performance has reduced.	▶ Replace the blade. (See page 19)
	▶ Replace the alkaline battery. (See page 9)
	▶ Apply oil. (See page 18)
	▶ Clean the inner blade. (See pages 15~17)
The appliance is not turned on.	▶ Place the alkaline battery correctly. (See page 9)
	▶ Replace the alkaline battery. (See page 9)
	▶ Confirm that the blade is properly attached.
Makes a loud sound.	▶ Apply oil. (See page 18)
	▶ Confirm that the blade is properly attached.

If the problems still cannot be solved, contact the store where you purchased the appliance or a service center authorized by Panasonic for repair.

Specifications

Power supply	Dry-cell battery
Battery type	One LR6 (AA alkaline battery) (Sold separately)

English

This product is intended for household use only.

Panasonic

使用說明書
(家用) 毛髮修剪器
型號 ER-GK20

目錄

安全須知.....	24
部件名稱.....	27
安裝電池.....	28
使用前請先閱讀.....	29
使用方法.....	31
保養.....	34
疑難排解.....	38
規格.....	38

感謝您購買本Panasonic產品。
操作本產品之前，請仔細閱讀本說明書。請妥善保存本說明書以供未來使用。

23



中文

安全須知



為減低受傷、死亡、觸電、火警及財物損失的風險，請必須遵從以下安全須知。

符號說明

以下符號用於為危險、傷害及財物損失的級別分類和作出解釋。若不理會此等符號，不當使用本產品就可能導致所述的危險、人身傷害及財物損失。

 警告	表示潛在的危險可能會導致嚴重受傷或致命。
 注意	表示可能會導致輕微受傷或財產損失的危險。

以下符號用於分類和解釋必須留意的指示類型。

 此符號用於提示用戶，不得執行某項特定的操作程序。
 此符號用於提示用戶，必須遵從某項特定的操作程序，藉以安全操作本產品。

警告

▶ 防止意外

 切勿將產品存放於兒童或幼童可觸及的地方。切勿讓兒童或幼童使用本產品。

- 將零件或配件放入口中，可導致意外或受傷。

 如出現異常或故障，應立即停止使用本產品。

- 否則可導致火警或受傷。

假如不慎吞服潤滑油，切勿迫使自己嘔吐，應飲用大量清水並前往就醫。

 假如雙眼接觸到潤滑油，應立即用清水徹底沖洗雙眼並前往就醫。

- 否則可導致身體健康問題。

 患有體能、感官或智力減退，或缺乏經驗和知識之人士（包括兒童），在無人監管或未獲告知如何使用的情况下不得使用本電器。

兒童應受到監視，確保兒童無法把玩本產品。

- 否則可導致意外或受傷。

注意

▶ 保護肌膚

切勿用刀片按壓皮膚。

切勿將本產品用於修剪體毛之外的任何用途。

切勿在沒有梳頭的情況下，使用本產品修剪敏感區、臀部、肛門及周圍部位的毛髮。

 切勿在以下身體部位使用本產品：

• 面部或頭部（頭髮、鬍鬚等）

• 皮膚粗糙或凹凸不平的部位（腫脹部位、割傷、痔瘡及其他凸起部位；乳頭及鄰近部位）

• 痣、瘀傷等

- 否則可導致皮膚受傷。

注意

切勿用力按壓刀片。此外，切勿用指甲接觸刀片。



切勿讓刀片接觸硬物。

- 由於刀片十分纖薄，此舉可令刀片損壞，並導致皮膚受傷。使用時請格外小心。



使用本產品前，應檢查確認刀片沒有變形或損壞。

- 否則可導致皮膚受傷。



存放及攜帶時，必須裝上梳頭。

- 否則可導致皮膚受傷，或縮短刀片的使用壽命。

▶ 本產品



切勿與您的家人或他人共用本產品。

- 否則可導致感染或發炎。



切勿掉下產品或使其受到撞擊。

- 否則可導致受傷。



切勿改裝、拆解或維修產品。

- 否則可導致意外或受傷。

→請聯絡授權維修中心以作維修。

▶ 電池



切勿丟入火中或拆解。

切勿讓供電端子間形成短路。

- 否則可能導致灼傷或傷害。

請務必遵守印在電池上的注意事項。

檢查電池的極性（+和-）並正確安裝。

電量耗盡後，請立即取出電池並以安全方式處置。



長時間不使用本產品時，請取出電池。

請在建議的使用期限之前使用電池。

請勿為非充電式電池充電。

- 否則可導致電池過熱或爆炸、人身傷害，或者因洩漏而令周圍環境受到污染。

部件名稱

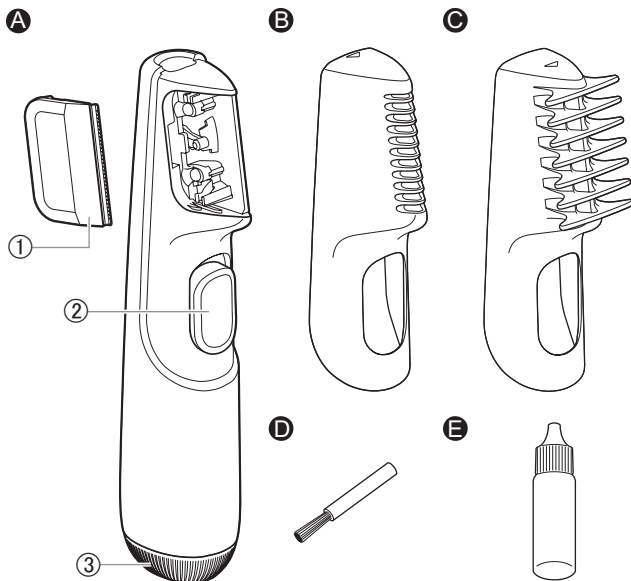

A 主機

- ① 刀片
- ② 電源開關 [O/I]
- ③ 電池蓋

B 股溝專用梳頭

C 長度調節梳頭 (3 mm)

配件

- D 清潔刷
- E 潤滑油

鹼性乾電池須另行購買。

安裝電池



- 確保主機已經關閉。

1. 取下電池蓋。

將電池蓋的凹位以箭咀所示的方向轉動，直至可取下電池蓋。

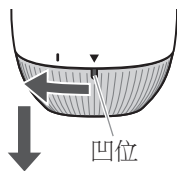

2. 檢查確定正負極（+和-）位置正確，然後裝入電池。

徹底抹乾主機，以防止在安裝電池時讓水滴進入主機內部。

3. 裝上電池蓋。

(1) 將電池蓋上的凹位與「┃」記號對齊，然後推入電池蓋。

(2) 轉動電池蓋，直至凹位與主機的「▼」記號對齊。

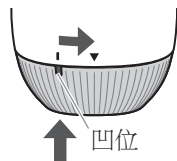

註

- 如使用一顆PanasonicLR6 (AA鹼性乾電池)，本電器大約可使用3個月。(上述為每次使用約5分鐘、每週一次，室溫為20 °C的情況。)
- 請確保使用LR6 (AA鹼性乾電池)。

使用前請先閱讀

使用部位

✓ 可以 ✗ 切勿使用

部位		安裝梳頭時 使用	不安裝梳頭 時使用
敏感區			
<ul style="list-style-type: none"> • 外陰部位 • 陰部 • 胯部 		✓	✗
<ul style="list-style-type: none"> • 臀部 • 肛門 • 肛門周邊 		✓	✗
腋下		✓	✓
胸口		✓	✓
肚臍部位		✓	✓
手臂、手部		✓	✓
腿部		✓	✓

- 使用本產品修剪無法看到的部位，可導致割傷或人身傷害。請小心使用。

- 使用主機修剪以下所示的部位 ()，可導致割傷或人身傷害。
請確保使用梳頭。

敏感區



臀部

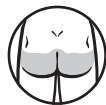

註

- 應拉緊皮膚鬆弛或有皺紋的部位，然後用刀片或梳頭邊緣輕力修剪。
- 切勿在濕潤的毛髮上使用梳頭。
濕潤的毛髮可能會聚集一起或黏住皮膚，使其難以修剪。如果您使用梳頭修剪濕潤的毛髮，就可能無法達到整齊均一的修剪效果。
- 在毛髮生長較厚或較濃密的部位，應逐少修剪。毛髮有時會在梳頭上卡住或積聚。如出現這種情況，應清潔梳頭。
(見第34~36頁。)

使用方法

首次使用本產品時，請將主機輕力放在皮膚上，嘗試修剪毛髮。

準備

- 使用本產品前，應檢查確認刀片沒有損壞或變形。
- 每次使用前後，都應在刀片上塗上潤滑油。
(見第36頁)

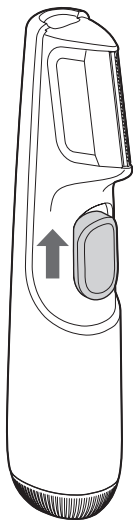

修剪乾燥毛髮

- 請根據需要使用合適的梳頭。
(見第32~33頁)

修剪濕潤毛髮

- 修剪濕潤的毛髮時，切勿使用梳頭。
- 請先弄濕需要修剪的部位，並塗上肥皂。
- 修剪乾燥毛髮時，應施加較少的壓力，然後以滑動方式移動主機。

1. 推動主機的電源開關，開啟電源。
放在皮膚上，並移動主機。
(見第32~33頁。)
2. 使用之後，推動主機的電源開關，關閉電源。
 - 每次使用之後，請清潔本電器。
- 否則可導致刀片變鈍。
(見第34~36頁。)

不使用梳頭時



輕力按壓，並往毛髮生長的相反方向慢速移動主機。



- 如要修剪臍毛，應將刀片平放在皮膚上，然後以滑動方式移動主機。這種做法可將毛髮長度修剪至大約**0.1 mm**。
- 將任何一邊刀片置於皮膚上修剪均可。（見第29頁）

股溝專用梳頭



將股溝專用梳頭的邊緣輕力放在皮膚上，然後慢速移動主機。

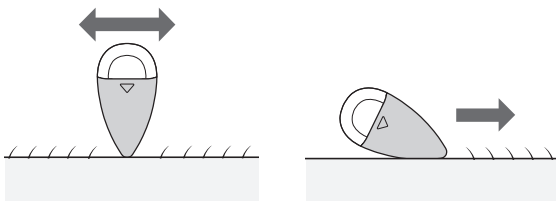

這種做法可將毛髮長度安全地修剪至大約**2 mm**。

長度調節梳頭



將長度調節梳頭的邊緣（平坦位置）輕力放在皮膚上，然後慢慢移動主機。

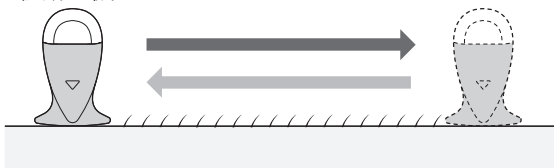

這種做法可將毛髮長度修剪至大約3 mm。

拆除及安裝梳頭

- 確保主機已經關閉。

拆除方法

以圖中所示方式握住主機，並以拇指和食指按住梳頭將其拆出。

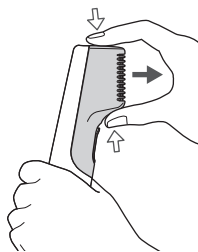

安裝方法

以箭咀所示的方向推入梳頭。

- 確保梳頭沒有掉下。

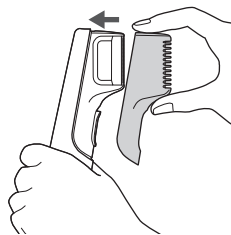

- 圖中顯示股溝專用梳頭。

- 所有梳頭的拆除和安裝方法相同。

保養

清潔

- 每次使用之後，應清潔主機和刀片。
(如果沒有清潔，修剪器就可能無法移動暢順，刀片亦會變鈍。)
- 確保主機已經關閉。
- 確保在裝上電池蓋後才清潔本電器。
- 切勿使用稀釋劑、揮發油、酒精或其他化學物品。否則可導致主機故障、破裂或褪色。只應用沾有少量水喉水或皂水的軟布清潔主機。
- 使用修剪器後，將主機存放於濕度低的位置。否則可能會因凝結或生銹而導致產品故障。
- 清潔之後，裝上梳頭並妥善存放。

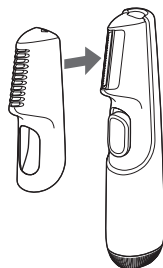

► 用清水沖洗

去除少量污漬
(直接用清水清潔)

1. 拆除梳頭。
2. 開啟電源，用清水徹底沖洗主機背面的進水口約20秒。
 - 關閉修剪器。



去除頑固污漬

1. 拆下梳頭和刀片。
2. 用清水沖洗。

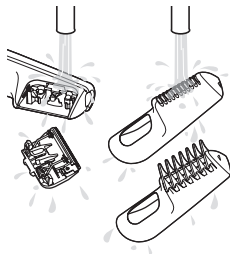

3. 將修剪器上下揮動數次，去除水份。
 - 排走水份時，請小心不要讓主機撞到洗手盤或任何其他物件。否則可導致產品故障。

4. 用毛巾抹走水份，然後讓其風乾。
 - 刀片在取出後可更快風乾。
5. 風乾之後，在刀片上塗上潤滑油。(見第36頁)

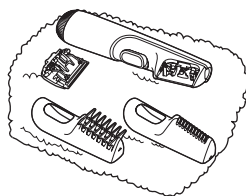

► 使用清潔刷

1. 掃走修剪後的毛髮。

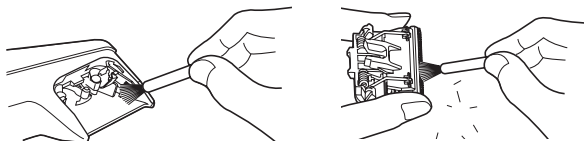

- 按下清潔桿後，清潔兩塊刀片中間的位置。

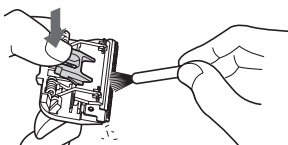

2. 清潔之後，在刀片上塗上潤滑油。 (見本頁)

潤滑

每次使用前後，都應在刀片上塗上潤滑油。

1. 拆下刀片。
(見第37頁)
2. 將一滴潤滑油滴在每個所示位置。
3. 將刀片安裝到主機上，開啟電源，然後讓修剪器運作大約5秒。

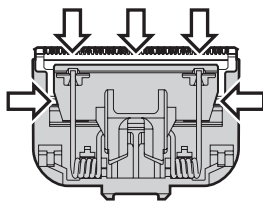

► 更換部件

更換部件在經銷商或本公司的授權維修中心有售。

ER-GK20更換部件	刀片	WER9500
-------------	----	---------

拆除及安裝刀片

- 拆下並裝上刀片時，請檢查刀片有否變形或損壞。
- 確保修剪器已經關閉。

拆除刀片

1. 如圖所示握住主機。
2. 用拇指肚將刀片的金屬部分推向左邊。
 - 用其他手指接觸刀片亦可。
 - 請小心不要讓刀片掉落。

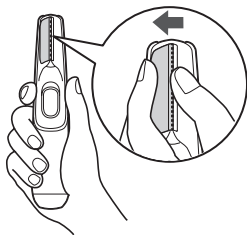

安裝刀片

1. 將安裝鉤 (B) 推入主機的刀片安裝位置 (A)，直至聽到「咔」的扣緊聲音。

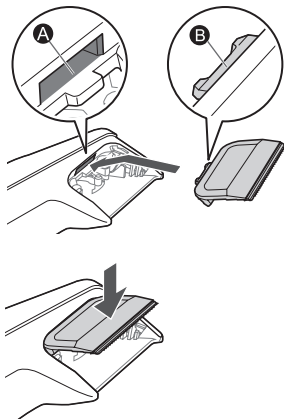

疑難排解

問題	方法
修剪效能變差。	▶ 更換刀片。 (見第37頁)
	▶ 更換鹼性乾電池。 (見第28頁)
	▶ 塗抹潤滑油。(見第36頁)
	▶ 清潔內層刀片。 (見第34~36頁。)
產品無法啟動。	▶ 正確放置鹼性乾電池。 (見第28頁)
	▶ 更換鹼性乾電池。 (見第28頁)
	▶ 確認刀片已正確安裝。
發出嘈雜聲響。	▶ 塗抹潤滑油。(見第36頁)
	▶ 確認刀片已正確安裝。

如果仍無法解決問題，請聯絡您購買本產品的店舖，或聯絡 Panasonic 授權服務中心以作維修。

規格

電源供應	乾電池
電池類型	一顆LR6 (AA鹼性乾電池) (需另購)

本產品只適合家居用途。

Panasonic Corporation
<http://www.panasonic.com>
© Panasonic Corporation 2020

© EN, HK

Printed in China
ER9700GK201401 S0520-0