

常見問題 Frequently Asked Questions

1 為甚麼浴室或廚房需要安裝抽氣扇？ Why do we need ventilating fans in kitchen or washroom?

浴室或廚房安裝抽氣扇，可把濕氣或油煙抽出室外，讓新鮮空氣經窗戶流入，填補被抽走的混濁空氣，改善室內空氣質素。
Ventilating fans help draw out stale air, excessive moisture and bring in fresh air, improving the quality of indoor air.

2 如何確保預留的窗戶空間已足夠安裝抽氣扇？
How to ensure enough space on the window for the installation of ventilating fan?

抽氣扇分為掛牆式及窗口式兩類，安裝掛牆式抽氣扇需在玻璃窗上開方形孔，而安裝窗口式抽氣扇則要在玻璃窗上開圓形孔。除了參照開孔尺寸外，亦需注意窗戶前方是否有足夠空間容納整部抽氣扇，包括面罩。各型號的實際所需面積可參考下列數字：

Ventilating fans are mainly divided into wall mount and window mount type, which respectively needs a square and round installation hole on the window. Apart from the size of installation hole, make sure there is enough space for the body as well, including the orifice. For actual installation area of different models, please refer to the figures below:

型號 Model	窗戶前方實際所需面積 (底 x 高) Actual Installation Area on the Window (Base x Height)
窗口式 Window Mount Type	
FV-15WH307, FV-15WJ107	≥390mm x 390mm
FV-20WH307	≥450mm x 450mm
FV-15WUL107, FV-15WU507	≥250mm x 400mm
FV-20WUL107, FV-20WU507	≥300mm x 420mm
掛牆式 Wall Mount Type	
FV-20AU907, FV-20DL307	≥400mm x 400mm
FV-25AU907, FV-25DL307	≥450mm x 450mm
FV-30AU907, FV-30AL707	≥500mm x 500mm
FV-15AST107	≥325mm x 325mm
FV-25AUF107	≥450mm x 550mm
FV-10BAT107	≥355mm x 305mm

3 抽氣扇使用電動背板有甚麼好處？ What are the advantages of electrically operated shutter?

由於電動背板只會隨電源開關而啟動或關上，加上開合角度穩定、受外界影響較小，適合安裝於當風或氣流大的位置。

The shutter is operated through electricity supply. While the shutter achieves a stable angle upon opening, it is less susceptible to any other influences. Therefore, it is more suitable for locations exposed to strong wind and airflow.

此產品目錄以環保紙及墨印刷
Printed with environmentally friendly ink on environmental paper.

本產品目錄只供參考，資料已經過細心核對，如有錯漏，以廠方生產的規格為準。
本公司保留更改產品設計及規格之權利，恕不另行通知。
如有任何爭議，信興電器貿易有限公司保留最終決定權。

This catalogue is for reference only. The product information is subject to manufacturer specifications.
The design and specifications of the products may be modified without prior notice.
In case of any dispute, Shun Hing Electronic Trading Co., Ltd. reserves the right of final decision.

7/2016

清新空氣 生活更美
Fresh Air for a Better Life



FV-15WJ107

嶄新扇葉設計¹ Advanced Blade Design¹

¹ FV-30AL707, FV-15AST107, FV-10BAT107 及 FV-30AU907除外
¹ Except FV-30AL707, FV-15AST107, FV-10BAT107 and FV-30AU907



嶄新扇葉設計採用空氣動力原理，能減少對氣流的任何阻力。

New blade design applies advanced aerodynamic principle that minimizes any obstacles against the airflow.

定風翼緣能減低扇葉後邊緣的亂流，其前方的弧度經改良後，有助氣流流動，並有效減少噪音。

Air Foil Chip reduces turbulence at rear edge, and curvature of front edge is improved for smooth airflow that minimizes fan noise as well.

全新HP摩打及軸承 New HP Motor & Bearing



與舊型號相比，新型號採用高性能電容式馬達及長壽命軸承，使產品更耐用持久。以掛牆式抽氣扇為例，平均使用時間由30,000小時增至60,000小時，能源消耗平均減少達13%。

Compared with previous models, new models adopt high performance condenser motor and long life bearing that prolong the product durability. As an example for wall mount ventilating fans, lifetime averages from 30,000 hours to 60,000 hours. They also enable energy saving by reducing power consumption by 13% on average.



網罩型 Louver Type

油滴收集過濾功能
Oil Collection & Filtration

■ FV-25AUF107(25cm/10")



多孔鋁質集油網-持久耐用
PERFORATED ALUMINUM FILTER – DURABLE

集油網採用鋁材製造，確保堅固耐用，並且容易拆下，清潔及保養。
The filter adopts aluminum material to assure excellent durability, and is easily detached for cleaning and maintenance.



易潔塗層-簡易清潔
EASY CLEAN COATING – CONVENIENT

可拆式鋁質集油網，經“Hydrophobic”易潔塗層處理。易潔塗層是一種氟化合物，能減低水份及油份與表面的接觸。這種材料的表面張力較低，從而使油滴下來而不會黏著。
The perforated aluminum filter is processed with an easy-clean coating named “Hydrophobic Coating”. It is basically a paint composed of fluorine compound particles that have small affinity with water or oil. This material has low surface tension allowing oil droplets to fall without adhering to the material.

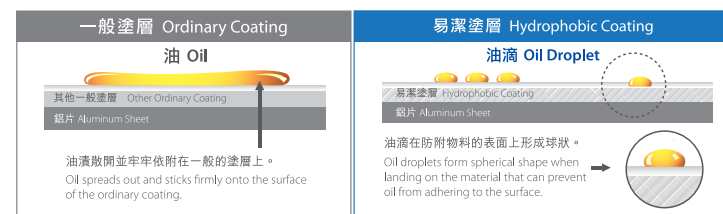

註：描繪圖樣，只作說明用途 Note: these are illustrations and for easy understanding only



卓越排氣功能
EXCELLENT EXHAUST PERFORMANCE

FV-25AUF107能承受高靜壓，在20Pa時，所承受的風量與25DL型號比較增加大約10%。因此更適用於需抵受強風的建築物，特別是高樓大廈。

FV-25AUF107 is sustainable to high static pressure. At 20Pa, its air volume is 10% more than 25DL model. Thus, it is more suitable for buildings exposing to strong wind, especially high-rise buildings.



收集油滴 - 配合環保
OIL COLLECTING - ENVIRONMENTALLY FRIENDLY

多孔集油網具備良好的收集油滴能力，排出室外的空氣可助減少污染，改善四周的空氣質素。
The perforated filter is competent in collecting oil. Consequently, the air exhausted to outdoors is less polluted and the surrounding air quality will be improved.

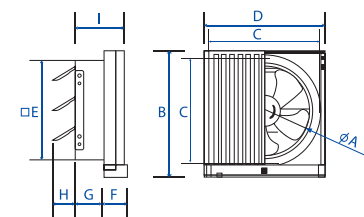

廚房專用 For Kitchen

型號 Model	毫米吋	A	B	C	D	E	F	G	H	I	安裝孔尺寸 Installation hole dimensions
FV-25AUF107	mm	250	371	310	352	290	65	90	70	150	300 x 300
	inch	9.8	14.6	12.2	13.9	11.4	2.6	3.5	2.8	5.9	11.8 x 11.8

符合防水安全規格IPX4(室外) / Comply with IPX4 (outside)

網罩型 Louver Type

電動背板開關設計
Electrically Operated Shutter

- FV-20DL307 (20cm/8")
- FV-25DL307 (25cm/10")

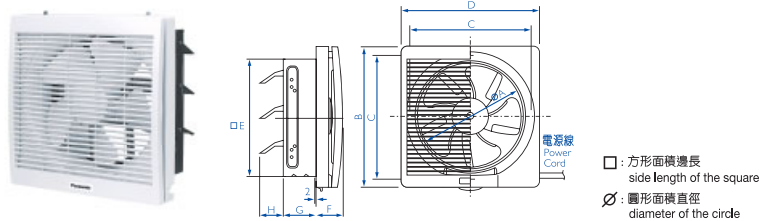

型號 Model	毫米吋	A	B	C	D	E	F	G	H	安裝孔尺寸 Installation hole dimensions
FV-20DL307	mm	200	306	260	302	240	68	90	80	250 x 250
	inch	7.9	12.0	10.2	11.9	9.4	2.7	3.5	3.1	9.8 x 9.8
FV-25DL307	mm	250	356	310	352	290	63	90	63	300 x 300
	inch	9.8	14.0	12.2	13.9	11.4	2.5	3.5	2.5	11.8 x 11.8

符合防水安全規格IPX4(室外) / Comply with IPX4 (outside)

單抽
Exhaust

標準型 Standard Type

- FV-20AU907 (20cm/8")
- FV-25AU907 (25cm/10")
- FV-30AU907 (30cm/12")

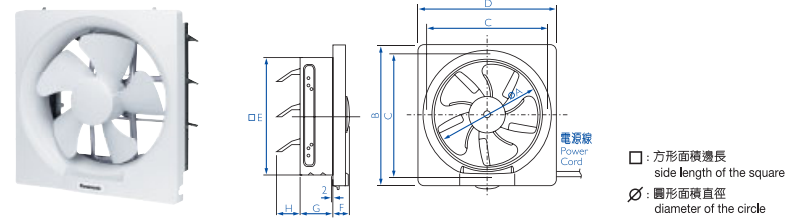

型號 Model	毫米吋	A	B	C	D	E	F	G	H	安裝孔尺寸 Installation hole dimensions
FV-20AU907	mm	200	306	260	302	240	52	90	80	250 x 250
	inch	7.9	12.0	10.2	11.9	9.4	2.0	3.5	3.1	9.8 x 9.8
FV-25AU907	mm	250	356	310	352	290	38	90	63	300 x 300
	inch	9.8	14.0	12.2	13.9	11.4	1.5	3.5	2.5	11.8 x 11.8
FV-30AU907	mm	300	406	360	402	340	38	90	78	350 x 350
	inch	11.8	16.0	14.2	15.8	13.4	1.5	3.5	3.1	13.8 x 13.8

符合防水安全規格IPX4(室外) / Comply with IPX4 (outside)

單抽
Exhaust

- FV-30AL707 (30cm/12")

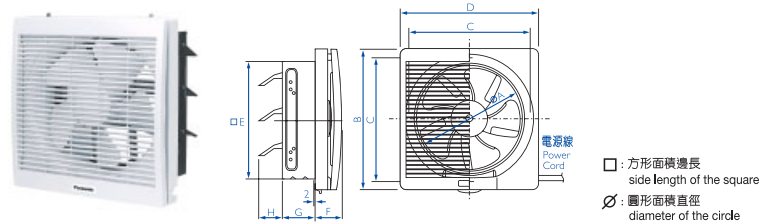

型號 Model	毫米吋	A	B	C	D	E	F	G	H	安裝孔尺寸 Installation hole dimensions
FV-30AL707	mm	300	406	360	402	340	63	90	78	350 x 350
	inch	11.8	16.0	14.2	15.8	13.4	2.5	3.5	3.1	13.8 x 13.8

符合防水安全規格IPX4(室外) / Comply with IPX4 (outside)

單抽
Exhaust

- FV-15AST107 (15cm/6")

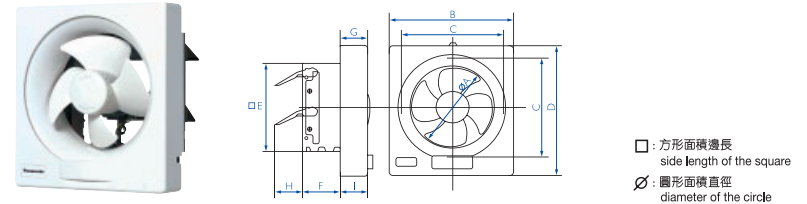

型號 Model	毫米吋	A	B	C	D	E	F	G	H	I	安裝孔尺寸 Installation hole dimensions
FV-15AST107	mm	150	240	195	254	170	75	55	54	52	175 x 175
	inch	5.9	9.4	7.7	10.0	6.7	3.0	2.2	2.1	2.0	6.9 x 6.9

符合防水安全規格IPX4(室外) / Comply with IPX4 (outside)

單抽
Exhaust

- FV-10BAT107 (10cm/4")

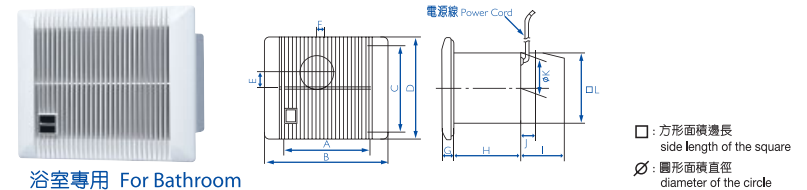

型號 Model	毫米吋	A	B	C	D	E	F	安裝孔尺寸 Installation hole dimensions
FV-10BAT107	mm	180	260	178	210	34	20	155 x 205
	inch	7.1	10.2	7.0	8.3	1.3	0.8	6.1 x 8.1
		G	H	I	J	K	L	
	mm	24	140	90	30	74	150 X 200	
	inch	0.9	5.5	3.5	1.2	2.9	5.9 x 7.9	

符合防水安全規格IPX4(室外) / Comply with IPX4 (outside)

單抽
Exhaust

浴室專用 For Bathroom



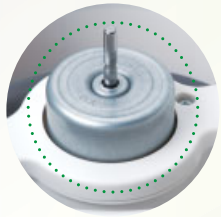

高性能電容式馬達* High Performance Condenser Motor

長壽命軸承* Long Life Bearing

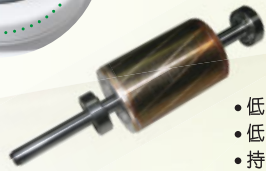

- 低耗電量 (跟15cm舊型號比較, 節省多達43%電量)
- 低噪音 (跟15cm舊型號比較, 減少噪音多達6%)
- 持久耐用 (較舊型號平均耐用1.5倍)
- 符合防水安全規格IPX4 (室外)
- Low power consumption (43% lower VS previous 15cm model)
- Low noise level (6% lower VS previous 15cm model)
- Long life (On average 1.5 times vs previous model)
- Comply with IPX4 (outside)

強化開關簾結構* Strengthened Shutter Structure

- 耐用
- 有效抵禦強風
- Durable
- Sustainable to strong wind

金屬製開關簾軸心, 產品更堅固耐用。
Metallic Shutter axis is used as the supporter for movement of shutter, providing a better endurance.



扇葉前緣 Leading Edge



定風翼緣 Air Foil Chip

先進扇葉設計* Advanced Blade Design

- 高風量
- 低噪音 (跟15cm舊型號比較, 減少噪音多達6%)
- 維持相同風量而轉速降低, 可有效減低噪音
- High air volume
- Low noise level (6% lower VS previous 15cm model)
- Maintains same air volume with lower R.P.M. that reduces noise level effectively

減低噪音 Noise Reduction

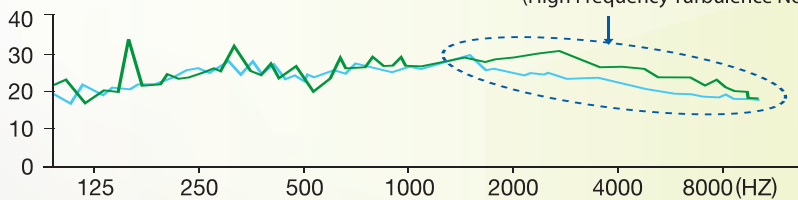

* WUL 及 WU 系列適用
* WUL & WU series only

網罩型 Louver Type

- FV-15WUL107 (15cm/6")
- FV-20WUL107 (20cm/8")

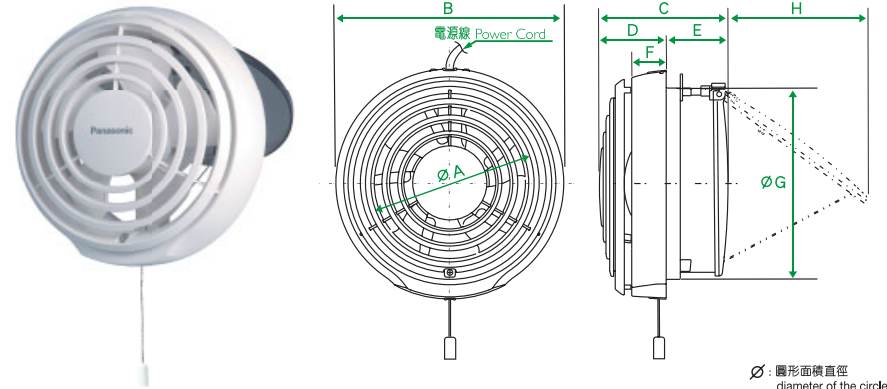

∅: 圓形面積直徑
diameter of the circle



型號 Model	毫米吋	A	B	C	D	E	F	G	H	安裝孔尺寸 Installation hole dimensions
FV-15WUL107	mm	150	210	119	65	54	38	177	149	∅186-188
	inch	5.9	8.3	4.7	2.6	2.1	1.5	7.0	5.9	∅7.3-7.4
FV-20WUL107	mm	200	271	127	65	62	36	237	201	∅247-250
	inch	7.9	10.7	5.0	2.6	2.4	1.4	9.3	7.9	∅9.7-9.8

符合防水安全規格IPX4(室外) / Comply with IPX4 (outside)

標準型 Standard Type

- FV-15WU507 (15cm/6")
- FV-20WU507 (20cm/8")

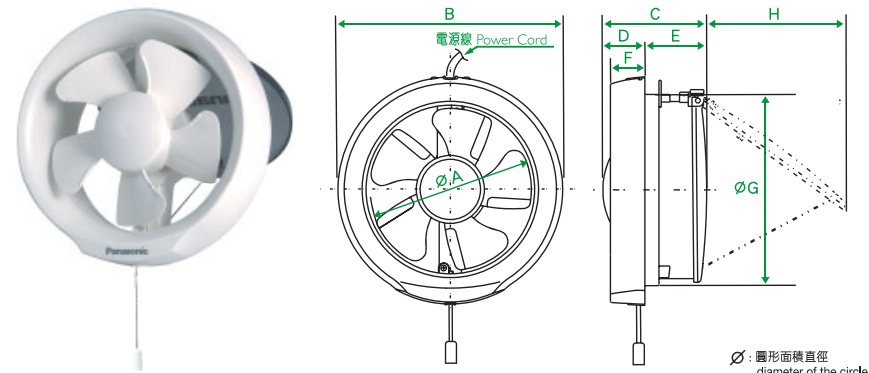

∅: 圓形面積直徑
diameter of the circle



型號 Model	毫米吋	A	B	C	D	E	F	G	H	安裝孔尺寸 Installation hole dimensions
FV-15WU507	mm	150	210	97	43	54	38	177	149	∅186-188
	inch	5.9	8.3	3.8	1.7	2.1	1.5	7.0	5.9	∅7.3-7.4
FV-20WU507	mm	200	271	98	36	62	36	237	201	∅247-250
	inch	7.9	10.7	3.9	1.4	2.4	1.4	9.3	7.9	∅9.7-9.8

符合防水安全規格IPX4(室外) / Comply with IPX4 (outside)

防風雨型 Hood Structure Type

電動背板開關設計
Electrically Operated Shutter

■ FV-15WJ107 (15cm/6")



遮風擋雨功能
Rain Proof and Wind Resistible

軸流扇在高靜壓下，仍能操作自如
Axial turbo type fan blade allows smooth operation under high static pressure

弧形雙百葉設計，遮風擋雨
Dome shaped hood with 2-piece shutter design, rain proof and wind resistible

強力通風及在高靜壓下運作
Powerful airflow and sustainable to high static pressure (Hi 90 Pa / Lo 51 Pa)

前置安全網，安全美觀
Attached front louver for safety and better appearance

附上左/右電線出口位，使安裝靈活度更高
3-way (upside/left/right) power cord opening for more flexibility

時尚設計
Modern design

兩種風速選擇
2-speed selectable

安裝簡便
Easy installation

方便清洗
Easy clean

安裝玻璃厚度5-9毫米
Recommended glass thickness 5-9mm

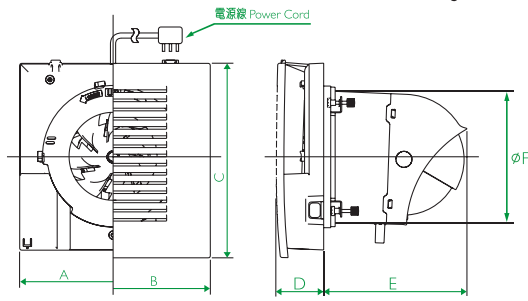

∅: 圓形面橫直徑
diameter of the circle

型號 Model	毫米吋	A	B	C	D	E	F	安裝孔尺寸 Installation hole dimensions
FV-15WJ107	mm	244	254	254	65	188	185.1	∅ 186-190
	inch	9.6	10.0	10.0	2.6	7.4	7.3	∅ 7.3-7.5

單抽
Exhaust

符合防水安全規格IPX4(室外) / Comply with IPX4 (outside)

防風雨型 Hood Structure Type

電動背板開關設計
Electrically Operated Shutter

新產品
New

■ FV-15WH307 (15cm/6") ■ FV-20WH307 (20cm/8")



機身附安裝螺絲
Installation screws included

弧形機背設計
Hood structure

先進扇葉設計，高靜壓下仍操作自如
Advanced blade design enables high performance under high static pressure (52 Pa)



弧形機背設計有效防止雨水進入
Hood structure prevents rain water ingress

背板末端呈掛勾形，有效擋風
Bended End Structure of shutter blocks backflow of outside wind
安裝簡便，只需擰緊機身安裝螺絲，無需使用膠墊和玻璃膠
Easy installation by tightening the installation screws on the body, no use of gasket and silicon seal

安裝玻璃厚度3-25毫米
Recommended glass thickness 3-25mm

網罩纖巧高雅，外形時尚美觀
Slim and elegant louver gives a stylish appearance

背板片數：
No. of Shutters：
FV-15WH307 : 3
FV-20WH307 : 4

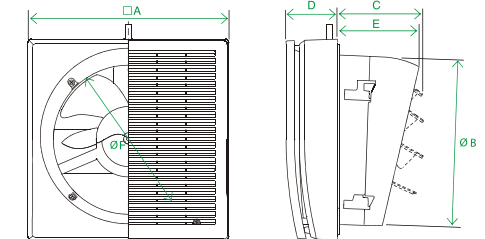

□: 方形面橫邊長
side length of the square
∅: 圓形面橫直徑
diameter of the circle

型號 Model	毫米吋	A	B	C	D	E	F	安裝孔尺寸 Installation hole dimensions
FV-15WH307	mm	224	182	117	72	111	160	∅ 186-188
	inch	8.8	7.2	4.6	2.8	4.4	6.3	∅ 7.3-7.4
FV-20WH307	mm	288	243	120	74	117	208	∅ 247-250
	inch	11.3	9.6	4.7	2.9	4.6	8.2	∅ 9.7-9.8

單抽
Exhaust

符合防水安全規格IPX4(室外) / Comply with IPX4 (outside)

規格 Specifications

型號 Model	抽氣方向 Air Direction	伏特 (V)	頻率 Hz	耗電量 Watt	轉速* R.P.M.*	排氣量 Air Volume CMH(CFH)	噪音水平 Noise dB(A)
-------------	-----------------------	-----------	----------	-------------	----------------	-------------------------------	------------------------

■ 掛牆式 Wall Mount Type

FV-20DL307	單抽 Exhaust	220	50	22	1,210	560 (19,776)	38
FV-25DL307	單抽 Exhaust	220	50	30	1,060	882 (31,147)	40
FV-20AU907	單抽 Exhaust	220	50	22	1,245	580 (20,480)	38
FV-25AU907	單抽 Exhaust	220	50	29	1,125	920 (32,490)	39
FV-30AU907	單抽 Exhaust	220	50	29	1,030	1,200 (42,380)	39
FV-30AL707	單抽 Exhaust	220	50	29	905	935 (33,020)	39
FV-15AST107	單抽 Exhaust	220	50	15	1,480	290 (10,241)	31

■ 廚房專用 For Kitchen

FV-25AUF107	單抽 Exhaust	220	50	34	1,100	835 (29,488)	42
-------------	------------	-----	----	----	-------	--------------	----

■ 浴室專用 For Bathroom

FV-10BAT107	單抽 Exhaust	220	50	15	1,250	77 (2,719)	40
-------------	------------	-----	----	----	-------	------------	----

■ 窗口式 Window Mount Type

FV-15WUL107	單抽 Exhaust	220	50	7.7	1,524	192 (6,780)	36
FV-20WUL107	單抽 Exhaust	220	50	16	1,093	342 (12,080)	39
FV-15WU507	單抽 Exhaust	220	50	7.7	1,524	210 (7,420)	34
FV-20WU507	單抽 Exhaust	220	50	17	1,205	420 (14,830)	39
FV-15WJ107	單抽 Exhaust(高Hi)	220	50	27	1,960	220 (7,770)	47
	單抽 Exhaust(低Lo)	220	50	24	1,460	165 (5,830)	38
FV-15WH307	單抽 Exhaust	220	50	13	2,290	230 (8,122)	43
FV-20WH307	單抽 Exhaust	220	50	20	1,370	445 (15,715)	42

*參考值 - 數值會因不同情況下有所改變 / Reference data - Value will be changed subject to different condition

選擇抽氣扇時，可按房間的大小而選擇適合該送風量的抽氣扇
Room size is considered when selecting appropriate Ventilating Fan

所選抽氣扇送風量
Air volume of selected
ventilating fan
(立方米/小時 m³/hr)

=

房間體積
Room size
(立方米 m³)

×

建議每小時換氣次數
Recommended no. of air
change per hour
(次/小時 n/hr)

建築物及房間類別 Type of building and room	浴室/洗手間 Bathroom/Toilet	廚房 Kitchen	學校課室 School Classroom	公司 Office
建議每小時換氣次數 Recommended no. of air change per hour (n/hr)	5-10	15	12-15	12-15
抽氣扇尺寸 Ventilating Fan Size	6"-8" (15cm-20cm)	10" (25cm)	10"-12" (25cm-30cm)	
建議預留通風口位 Recommended ventilation opening	2.5厘米高門腳空隙 2.5cm gap between the door and the floor	45 x 30厘米(百葉入氣口) 45 x 30cm (Louver Inlet)	45 x 30厘米(百葉入氣口) 45 x 30cm (Louver Inlet)	

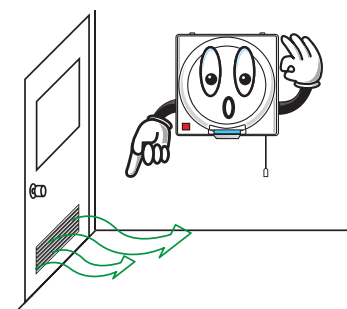

注意事項 Attention

房間內必需設置一通風口位，
使能達到有效的換氣效果。
Be sure to provide an appropriate
ventilation opening for
effective ventilation.

- 符合IPX4表示水從任何方向濺向產品時，對其安全性並無不良的影響。
IPX4 stands for ingress protection that water splashing against the product from any direction shall have no harmful effects on its safety.
- 安裝方法請參照操作說明書。
For installation method, please refer to the operation instruction.